

RELEASE NOTES SERIES 390

WHAT'S NEW IN VERSION 1.1.1

1. Screenshots

The Series 390 now offers a screenshot function that can be triggered via an external keyboard. The images in BMP format (800x480) are saved directly on a connected USB flash drive. These can be entered directly into documentation such as instructions, used for support requests or edited with any common image processing program.

Basically, all screen contents can be saved (menu, lists etc.).

Simple procedure

- Connecting the keyboard
- Connecting the USB flash drive
- Press CTRL + P
- Beep sounds after successful storage

Technical Requirements

- USB keyboard (any country code)
- USB flash drive (FAT32)

For detailed information, see [Application Note Screenshots](#).

2. Connectivity

Complete revision of the network communication. Balance can act both as a server and as a client. Both LAN and WLAN connections are supported.

Features

- Wide range of setting options
- Server function: Up to 5 clients can connect to the balance
- Replies to remote control commands are sent only to the emitting client.
- Data output (print, transfer & protocol) triggered by the balance is sent to all clients.
- Simplified network configuration
- Network status is displayed in the status bar when the connection is established.
- More detailed information can easily be displayed.

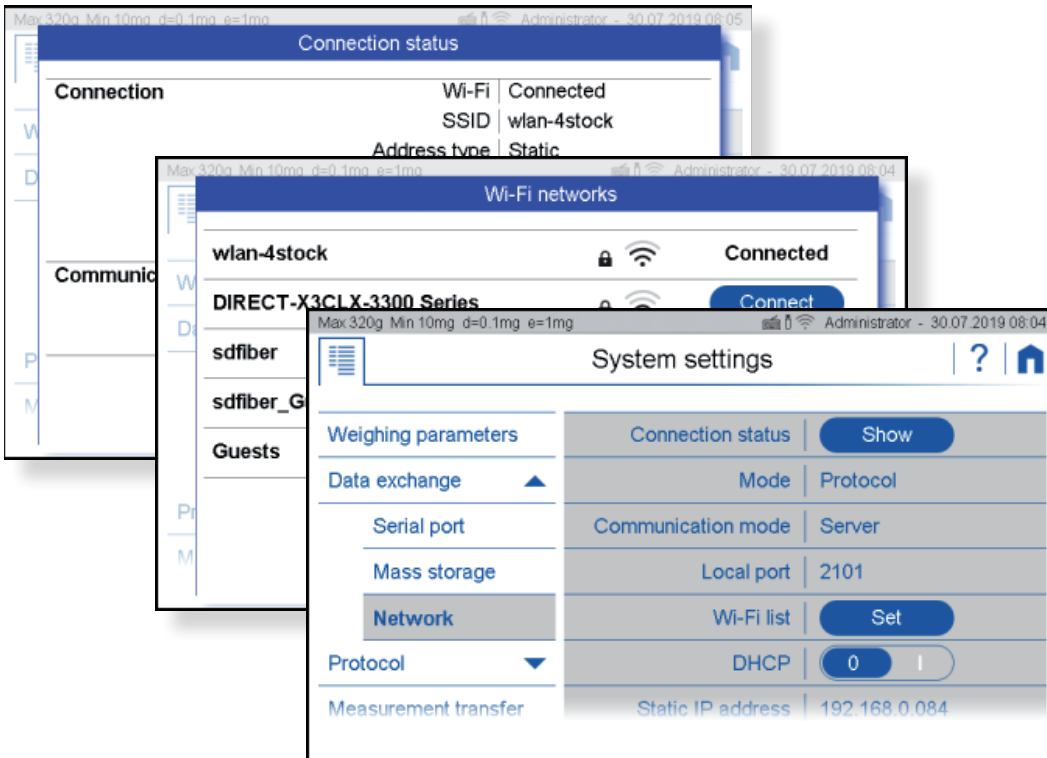

For detailed information, see [Application Note Network Communication](#).

WiFi-Module

WiFi-Module (350-8935)

Remote control commands

The commands available for communication with the balance can now be used via Ethernet (LAN and WLAN).

3. Bugfixes

As usual, minor bugs have been fixed to ensure the best possible user experience.